

**Physical Specification**

Nominal Voltage	6V
Nominal Capacity (20HR)	225Ah
Nominal Capacity (5HR)	185Ah

Length	260 ± 2mm (10.24 inches)
Width	180 ± 2mm (7.09 inches)
Container Height	248 ± 2mm (9.76 inches)
Total Height	279.5 ± 2mm (11.00 inches)

Dry Weight	Approx 20.0Kg (44.1lbs)
Wet Weight	Approx 27.0Kg (59.5 lbs)
Acid	1.280 ± 0.015g/cm <sup>3</sup> (25 )

Standard Terminal	LPT
Container Material	PP

**Electrical Specification**

Rated Capacity	20 hour rate (11.3A)	225Ah
	5 hour rate (37.0A)	185Ah
Reserve Capacity	25Amps	445min
	75Amps	115min

**Discharge Characteristics (25 °C 77 °F)**

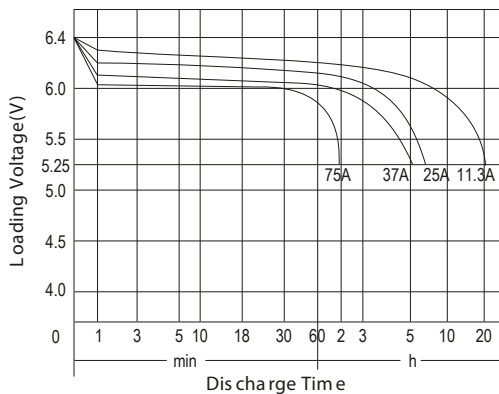

**SOLAR BATTERY  
DT 106 (6V-225AH)**

**Outer Dimensions**

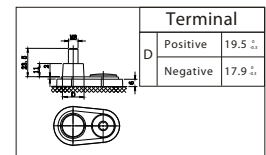
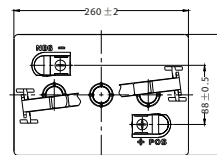
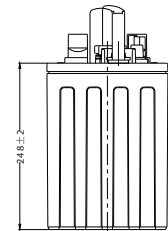
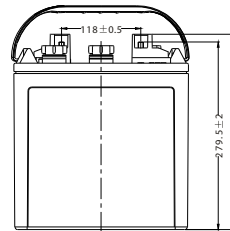

**Charge Method**

**Initial Charge**

- 1- 0.1 C<sub>20</sub> (A) charging 15h
- 2- 0.05 C<sub>20</sub> (A) charging 10h

The temperature of the battery should be below 50 °C during charging.

**Supplement Charge**

- a) Charging at a constant voltage of 7.35~7.5V/cell and a limited current 0.25 C<sub>20</sub> (A) until the electrolyte density up to 1.280 g/cm<sup>3</sup> (30°C) and the current not change for 3 hours.

- b) Charge with constant current 0.1C<sub>20</sub> (A) until the voltage between 7.8~8.4V/cell, and voltage maintains for 3 hours and not change.

Two method optional